

Standplan „Hamburg Open 2018“

14.09.2017

Studio A3

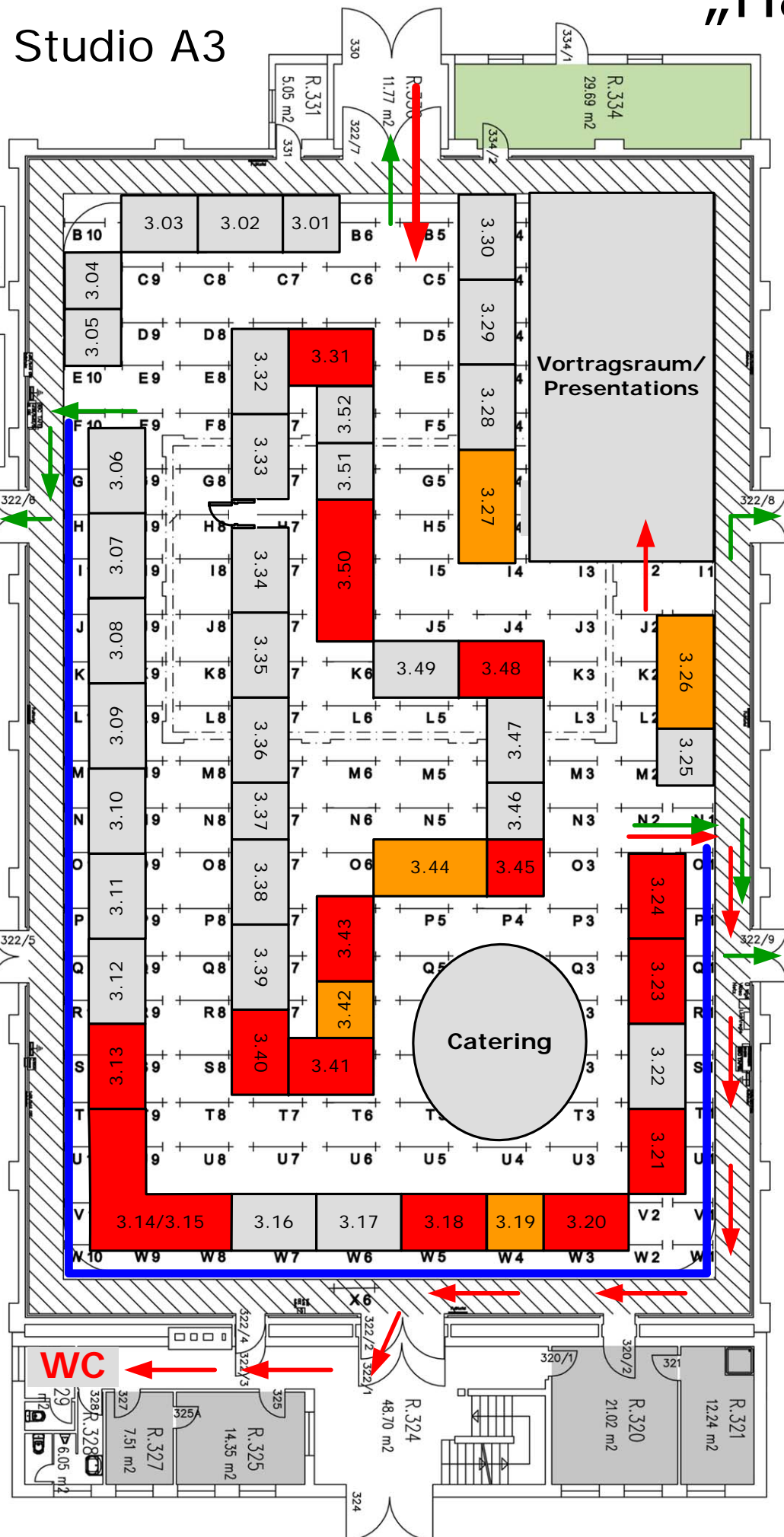

Studio A9/A10

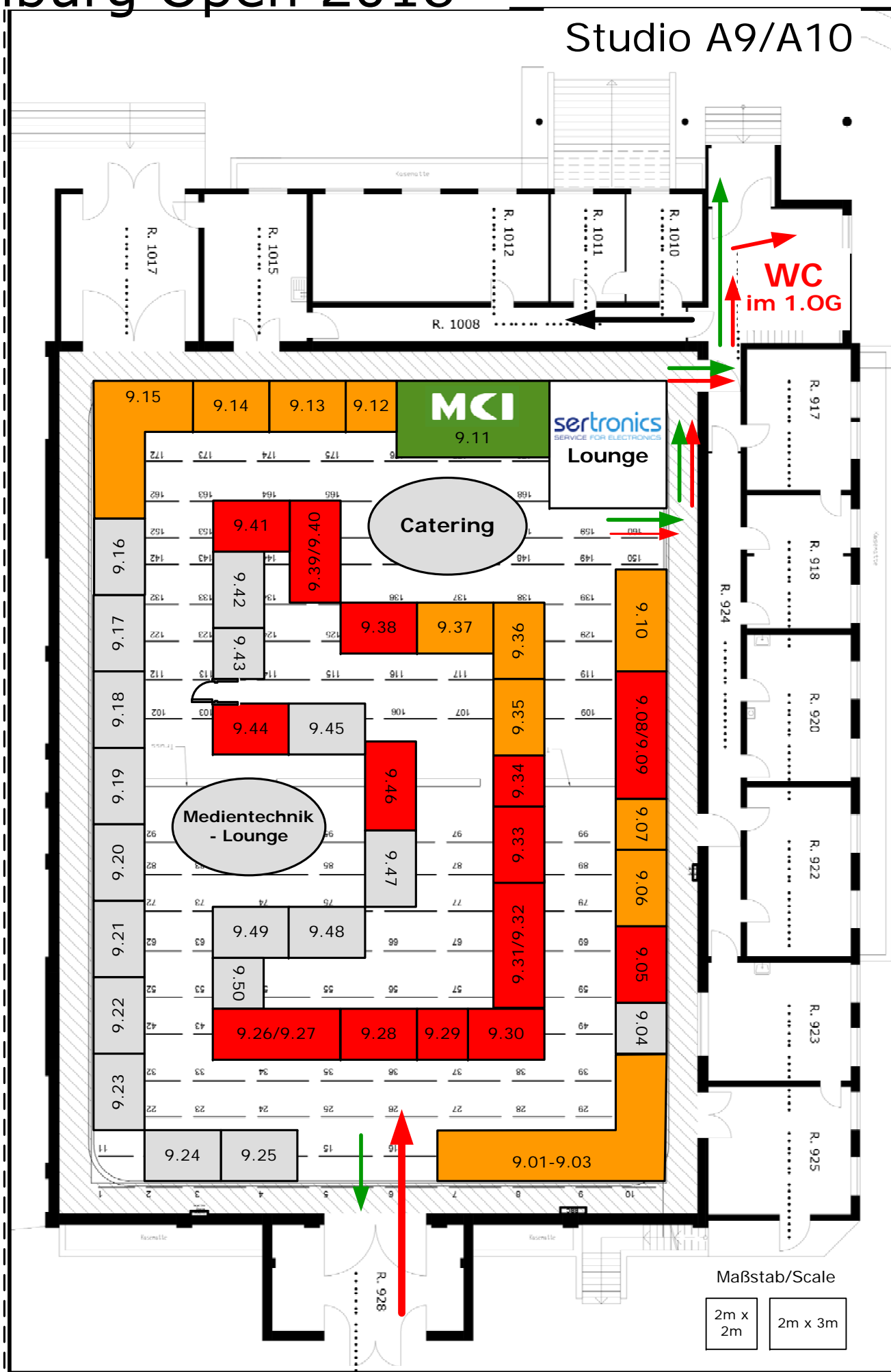

Standregister

Studio A3	Studio A9/A10
3.01:	9.01-9.03: Teracue
3.02:	9.04:
3.03:	9.05: KLOTZ AIS
3.04:	9.06/9.07: AJA
3.05:	9.08/9.09: Sony
3.06:	9.10: avt plus
3.07:	9.11: MCI
3.08:	9.12:
3.09:	9.13:
3.10:	9.14:
3.11:	9.15: Ross Video
3.12:	9.16:
3.13: Panasonic	9.17:
3.14/3.15: Production Concept	9.18:
3.16:	9.19:
3.17:	9.20:
3.18: BroaMan	9.21:
3.19: Easyrig	9.22:
3.20+3.21: Mediatec	9.23:
3.22:	9.24:
3.23: SonoVTS	9.25:
3.24: Equiprent	9.26/9.27: Stage Tec
3.25:	9.28: ADAM Audio
3.26: ComLine	9.29: Sound Service
3.27:	9.30: EVS
3.28:	9.31/9.32: LAWO
3.29:	9.33: JOWO
3.30:	9.34: Schwörer Ing.
3.31: IHSE	9.35: Adder
3.32:	9.36: MAT
3.33:	9.37: Damar & Hagen
3.34:	9.38: EditShare
3.35:	9.39/9.40: Elements
3.36:	9.41: Happyware
3.37:	9.42:
3.38:	9.43:
3.39:	9.44: Stryme
3.40: Sachsenkabel	9.45:
3.41: XineGear	9.46: Nachtblau
3.42: TSL	9.47:
3.43: MBF	9.48:
3.44: Hanse-Inno-Tech	9.49:
3.45: Vison2See	9.50:
3.46:	
3.47:	
3.48: don't panic die case-manufaktur	
3.49:	
3.50: Snell	
3.51:	
3.51:	

Maßstab/Scale

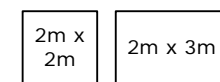

- Frei/Free
- Reserviert/Reserved
- Gebucht/Booked

→ Notausgänge/Emergency Exits