

Standplan „Hamburg Open 2019“

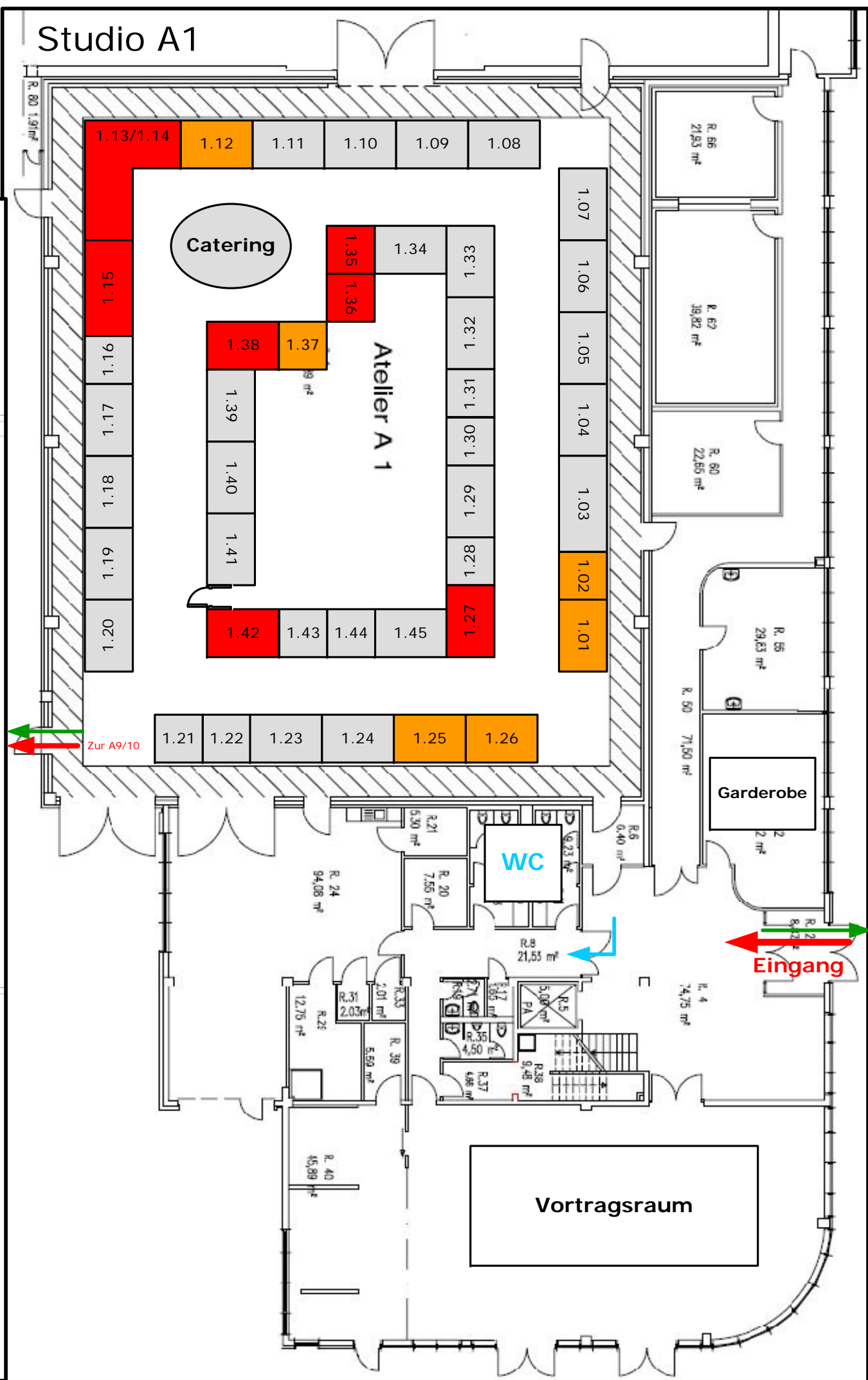

Standregister	
Studio A1	Studio A9/A10
1.01/1.02: IDX/CaSu	9.01: Teracue
1.03:	9.02: Teracue
1.04:	9.03: Teracue
1.05:	9.04:
1.06:	9.05: KLOTZ AIS
1.07:	9.06:
1.08:	9.07: Atlona Int. GmbH
1.09:	9.08: Damar-Hagen
1.10:	9.09: Ross Video
1.11:	9.10: Ross Video
1.12: Neutrik	9.11: STH Atelier
1.13/1.14: Mediatec	9.12: Domo Broadcast
1.15: avt plus	9.13:
1.16:	9.14:
1.17:	9.15: Damar-Hagen
1.18:	9.16: Haivision
1.19:	9.17: ZeigermannAudio
1.20:	9.18: Imagine
1.21:	Communications
1.22:	9.19:
1.23:	9.20: Quantum
1.24:	9.21:
1.25: BPM	9.22: SONY
1.26: BPM	9.23: SONY
1.27: Panasonic	9.24/9.25: PMT
1.28:	9.26:
1.29:	9.27:
1.30:	9.28/9.29: Stage Tec
1.31:	9.30: MAG
1.32:	9.31:
1.33:	9.32/9.33: Guntermann & Drunck GmbH
1.34:	9.33:
1.35: Vision2See	9.34: JOWO-Systemt.
1.36: Canare Europe	9.35: Logic Media
1.37: Ghisletti	9.36: EVS
1.38: Sachsenkabel	9.37:
1.39:	9.38: Editshare
1.40:	9.39: Elements
1.41:	9.40/9.41: Lawo
1.42: don't panic	9.42:
1.43:	9.43:
1.44:	9.44: Stryme
1.45:	9.45: SIGMA
	9.46/9.47: Lightequip
	9.48: Shure
	9.49: Connex (Fiberfox)
	9.50: Ikegami

Frei/Free
 Reserviert/Reserved
 Gebucht/Booked
 Notausgänge/Emergency Exits

2m x 2m
 2m x 3m
 Maßstab/Scale